

LONGi EcoLife

LR7-54HJD(Dual Glass)

480~490M

First Choice For High-End Residential

- ▶ **Ultimate Efficiency**
- ▶ **More Power Generation**
Exclusive HIBC technology, higher power generation in all scenarios
- ▶ **Longer Module Life**
Butyl rubber seals for better water resistance
- ▶ **Enhanced Safety Function**
Optimized Anti-Shading and Prevent Localized Overheating
- ▶ **Higher Hurricanes and Snow Resistance**
Enhanced Mechanical Load: 6000Pa/3600Pa
- ▶ **Low Carbon and Environmentally Friendly**
Low carbon for the whole lifecycle, more environmentally friendly

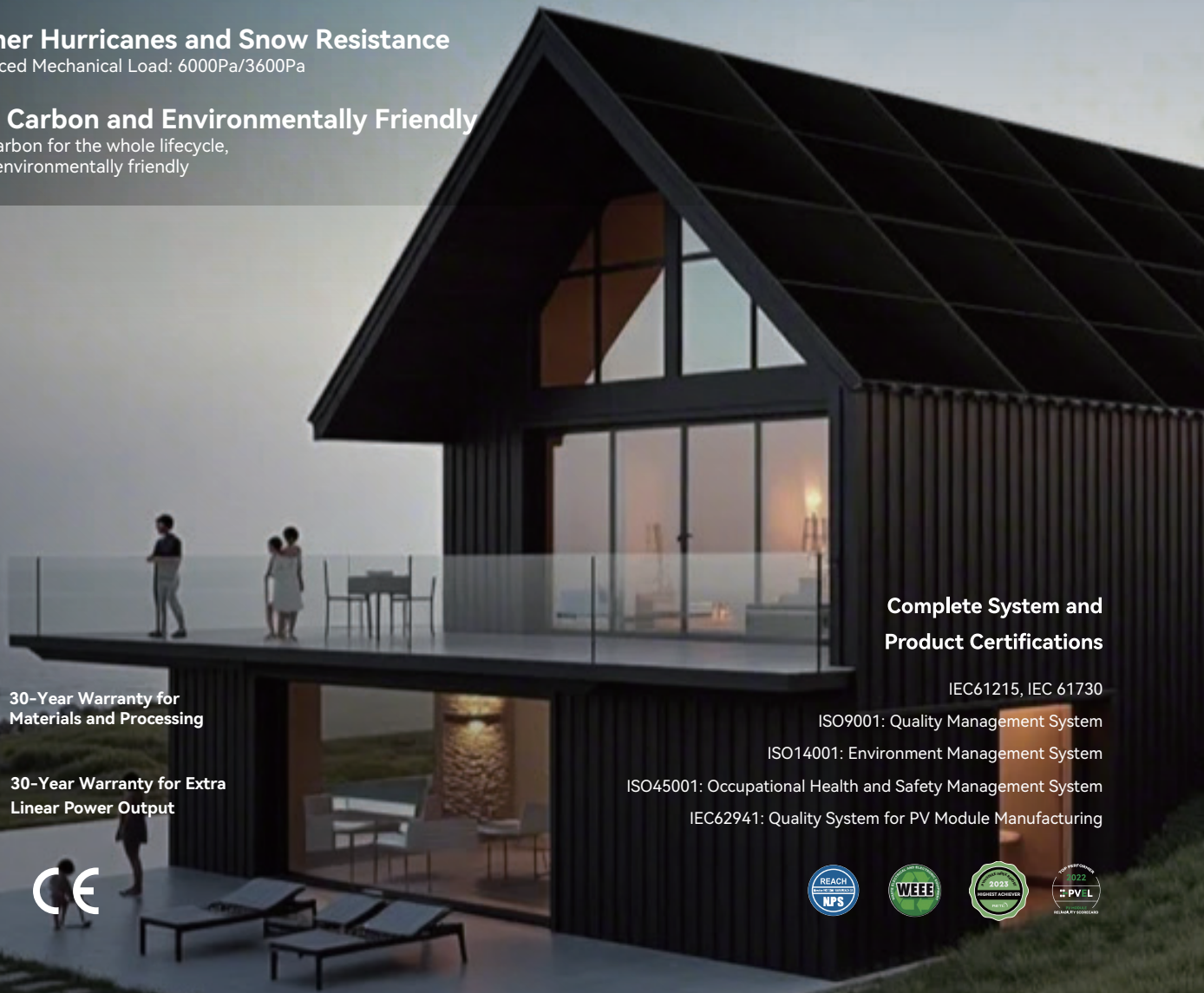

Complete System and Product Certifications

IEC61215, IEC 61730

ISO9001: Quality Management System

ISO14001: Environment Management System

ISO45001: Occupational Health and Safety Management System

IEC62941: Quality System for PV Module Manufacturing

30 30-Year Warranty for Materials and Processing

30 30-Year Warranty for Extra Linear Power Output



Residential PV Modules, Choose BC

LR7-54HJD 480~490M

24.0%
MAX MODULE
EFFICIENCY

0~3%
POWER
TOLERANCE

<1%
FIRST YEAR
POWER DEGRADATION

0.35%
YEAR 2-30
POWER DEGRADATION

BC-CELL
LOWER OPERATING
TEMPERATURE

Additional Value

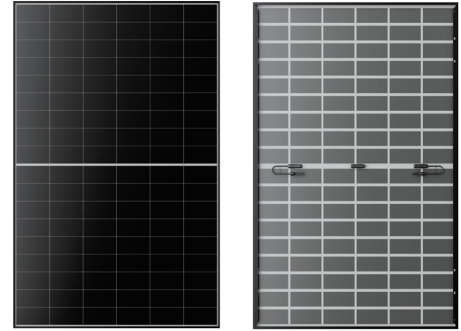
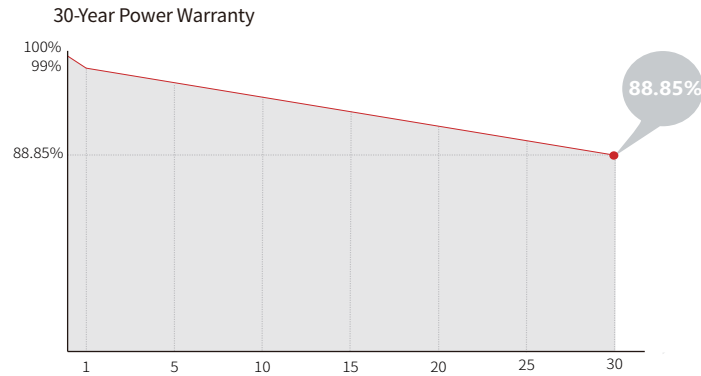

Mechanical Parameters

Cell Orientation	108 (6×18)
Junction Box	IP68
Output Cable	4mm ² , +400, -200mm/±1200mm length can be customized
Glass	Double glass 2.0mm semi-tempered glass+1.6mm semi-tempered glass
Frame	Black anodized aluminum alloy frame
Weight	23.5kg
Dimension	1800×1134×30mm
Packaging	36pcs per pallet / 216pcs per 20' GP / 864pcs per 40' HC

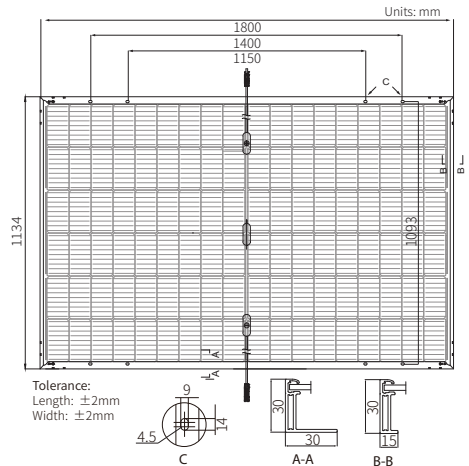

Electrical Characteristics

STC : AM1.5 1000W/m² 25°C

NOCT : AM1.5 800W/m² 20°C 1m/s

Test uncertainty for Pmax: ±3%

Module Type	LR7-54HJD-480M		LR7-54HJD-485M		LR7-54HJD-490M	
	STC	NOCT	STC	NOCT	STC	NOCT
Maximum Power (Pmax/W)	480	365	485	369	490	373
Open Circuit Voltage (Voc/V)	40.95	38.92	41.05	39.02	41.15	39.11
Short Circuit Current (Isc/A)	14.86	11.93	14.97	12.02	15.08	12.11
Voltage at Maximum Power (Vmp/V)	33.77	32.09	33.87	32.18	33.97	32.28
Current at Maximum Power (Imp/A)	14.21	11.39	14.32	11.47	14.42	11.56
Module Efficiency(%)	23.5		23.8		24.0	

Electrical characteristics with different rear side power gain (reference to 505W front)

Pmax/W	Voc/V	Isc /A	Vmp/V	Imp /A	Pmax gain
530	41.45	16.18	34.27	15.47	5%
556	41.45	16.95	34.27	16.21	10%
581	41.55	17.72	34.37	16.90	15%
606	41.55	18.49	34.37	17.63	20%
631	41.55	19.26	34.37	18.37	25%

Operating Parameters

Operational Temperature	-40°C ~ +85°C
Power Output Tolerance	0 ~ 3%
Maximum System Voltage	DC1500V (IEC)
Maximum Series Fuse Rating	30A
Nominal Operating Cell Temperature	45±2°C
Protection Class	Class II
Fire Rating	IEC Class C

Mechanical Loading

Front Side Maximum Static Loading	6000Pa
Rear Side Maximum Static Loading	3600Pa
Hailstone Test	25mm Hailstone at the speed of 23m/s

Temperature Ratings (STC)

Temperature Coefficient of Isc	+0.050%/°C
Temperature Coefficient of Voc	-0.210%/°C
Temperature Coefficient of Pmax	-0.240%/°C



Specifications included in this datasheet are subject to change without notice. LONGI reserves the right of final interpretation. (BGV02 20250527)